

# Functional ceiling



# Functional ceiling, basic system

With these parts a rectangular functional ceiling can be built up.  
No tools needed for mounting channel or cover to the hub.



## Technical Specification

Functional ceiling with grid modules of 2000 x 2000 mm.  
Channel in sheet metal, available in white Color RAL9010.  
No tool needed for installation between hubs and channels. Accessories to attach decoration and electrical installation are available.

Pos.	Article no.	Description	
1	244-201-001	Channel hub	Basic system
2	244-202-001	Channel c-c 2000	
3	244-309-001	Channel lock	
4	244-203-001	Cover	
5	244-328-001	Corner cover	
6	244-311-001	Wall bracket	Suspension
7	244-207-001	Wall bracket, adjustable	
8	244-310-001	Offset suspension point	
9	244-312-001	Reinforcement plate	Accessories
10	244-208-001	Decor channel	
11	244-323-001	Sliding decor hook	
12	244-205-001	Channel with hooks	
13	244-325-001	End cover for cut channel	
14	244-308-001	Mounting plate	

## Load on ceiling system

Max weight load: 5kg / m<sup>2</sup> (\*)  
Max weight load on hub: 20kg / hub (\*)  
Max weight load on corner hub: 10kg / hub (\*)

Total system weight = 6kg / Suspension point.

(\*): Added load, excluding weight of system parts.

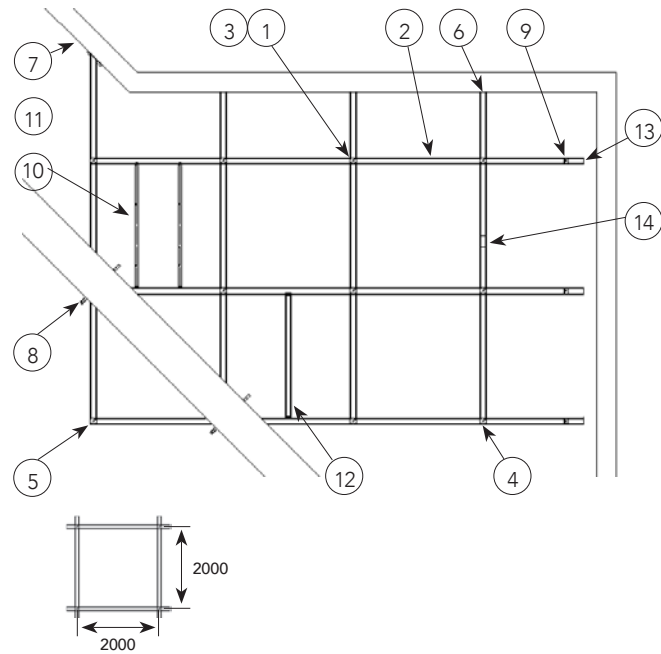

## L, T and X crossings

Pictures below shows the components needed to make L, T and X crossings.  
To every hub (244-201-001) 4 channel lock (244-309-001) is used to secure the channels (244-202-001) or covers (244-203-001 or 244-328-001). Threaded rod M6 with nuts needed for every hub (not supplied).

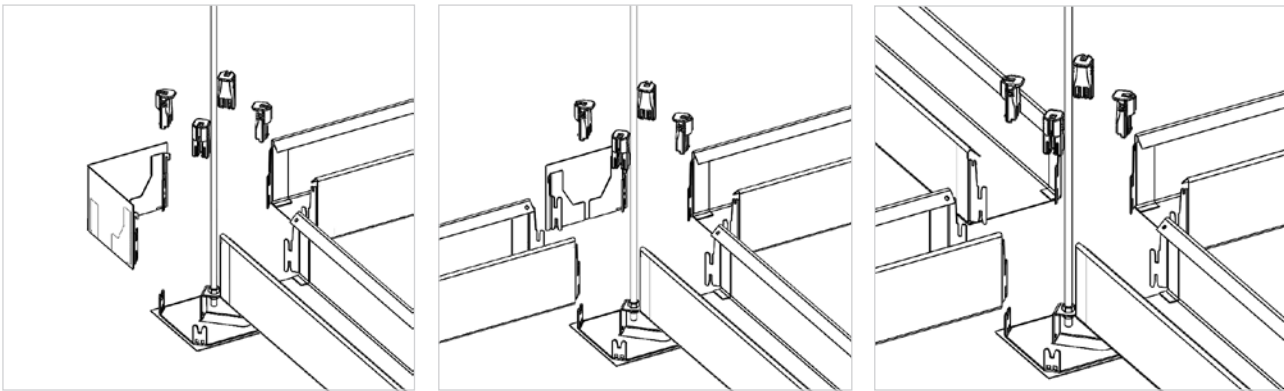

## Functional ceiling, suspension

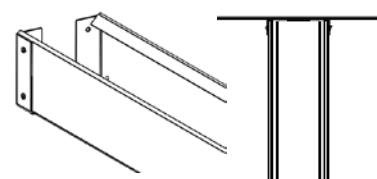
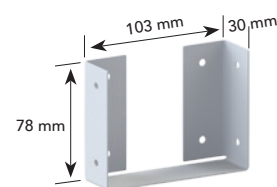

### Wall bracket

244-311-001

Cut channel mounted to wall perpendicular to the channel.

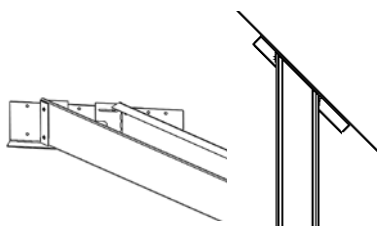
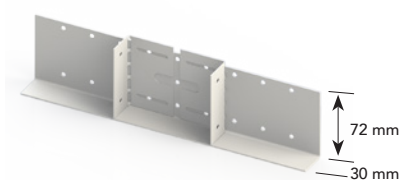

### Wall bracket, adjustable L=300

244-207-001

Wall support of a channel when the wall is not perpendicular to the channel. Can be adjusted to different angles between channel and wall.

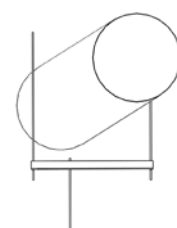
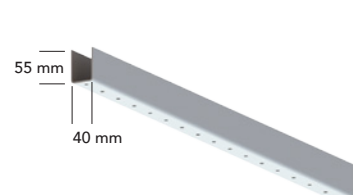

### Offset suspension point, L=830

244-310-001

Used to move suspension when e.g. ventilation duct is interfering. Threaded rod M6 with nuts needed (not supplied).

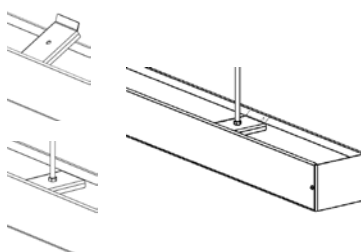
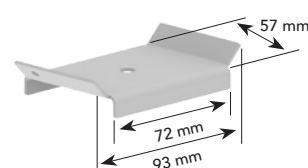

### Reinforcement plate

244-312-001

Used to add an extra suspension point to a channel for increasing load capacity. Also used when a channel is cut. Threaded rod M6 with nuts needed (not supplied).

## Functional ceiling, accessories

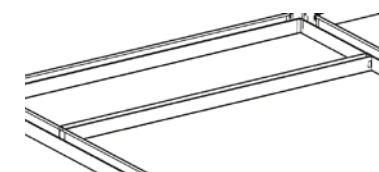
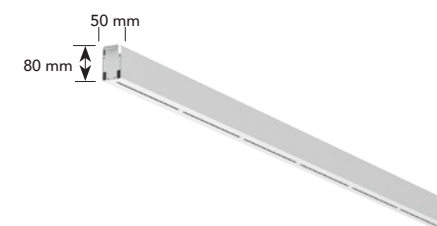

### Decor channel, c-c 2000

244-208-001

Can be mounted anywhere in the grid and got slotted holes on bottom for flexible placement of sliding decor hook (244-323-001).

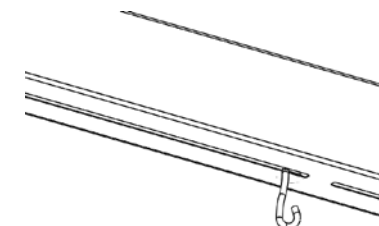
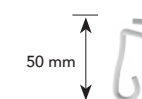

### Sliding decor hook

244-323-001

Mounted in decor channel (244-208-001) to hold signs, information banners, price tags etc.

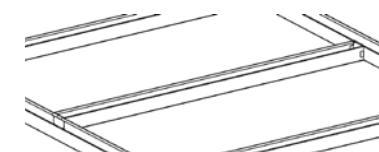
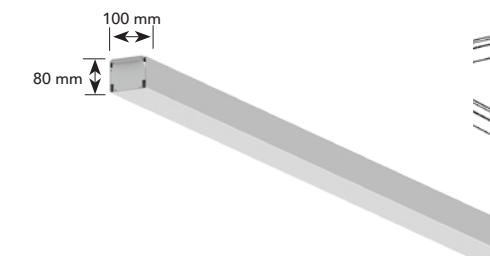

### Channel w. hooks, c-c 2000

244-205-001

Can be mounted anywhere in the grid for flexible placement of e.g. luminaires.

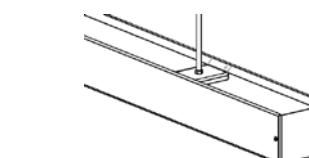
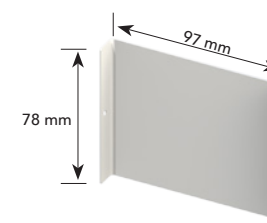

### End cover for cut channel

244-325-001

Cover for cut channels. Reinforcement plate (244-312-001) must be mounted on the cut channel for suspension.

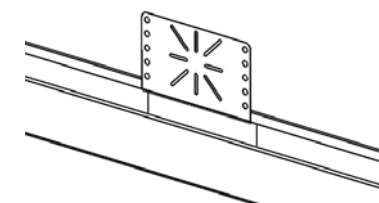
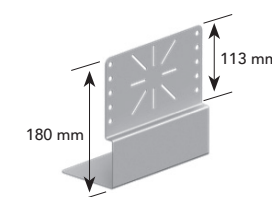

### Mounting plate, L=185

244-308-001

Flexible mounting plate for power outlet and other electrical installations.