

Nano 2

ITAB

System

MODULAR SYSTEMS

ELECTRIFIED TRACK SYSTEM FOR STORE DISPLAY FIXTURES



RETHINK RETAIL.TOGETHER.

Nano 2

System

Customisation and flexibility in mass market retail: a complete plug-and-play lighting solution for store display fixtures.



The system features a versatile electrified track and high-efficiency, low-consumption LED lamps that can be easily integrated into existing facilities and display solutions. These lamps can be safely and quickly repositioned without affecting the display's aesthetic appearance.

IDEAL FOR

- mass market retail
- perfumery
- pharmacy
- food stores

The magnetic fixing feature makes Nano 2 System the ideal solution for metal display fixtures, while the wide range of high quality power supplies makes the system even more adaptable to every need.

FEATURES

- Energy and cost saving
- easy installation
- ideal for existing facilities

System overview

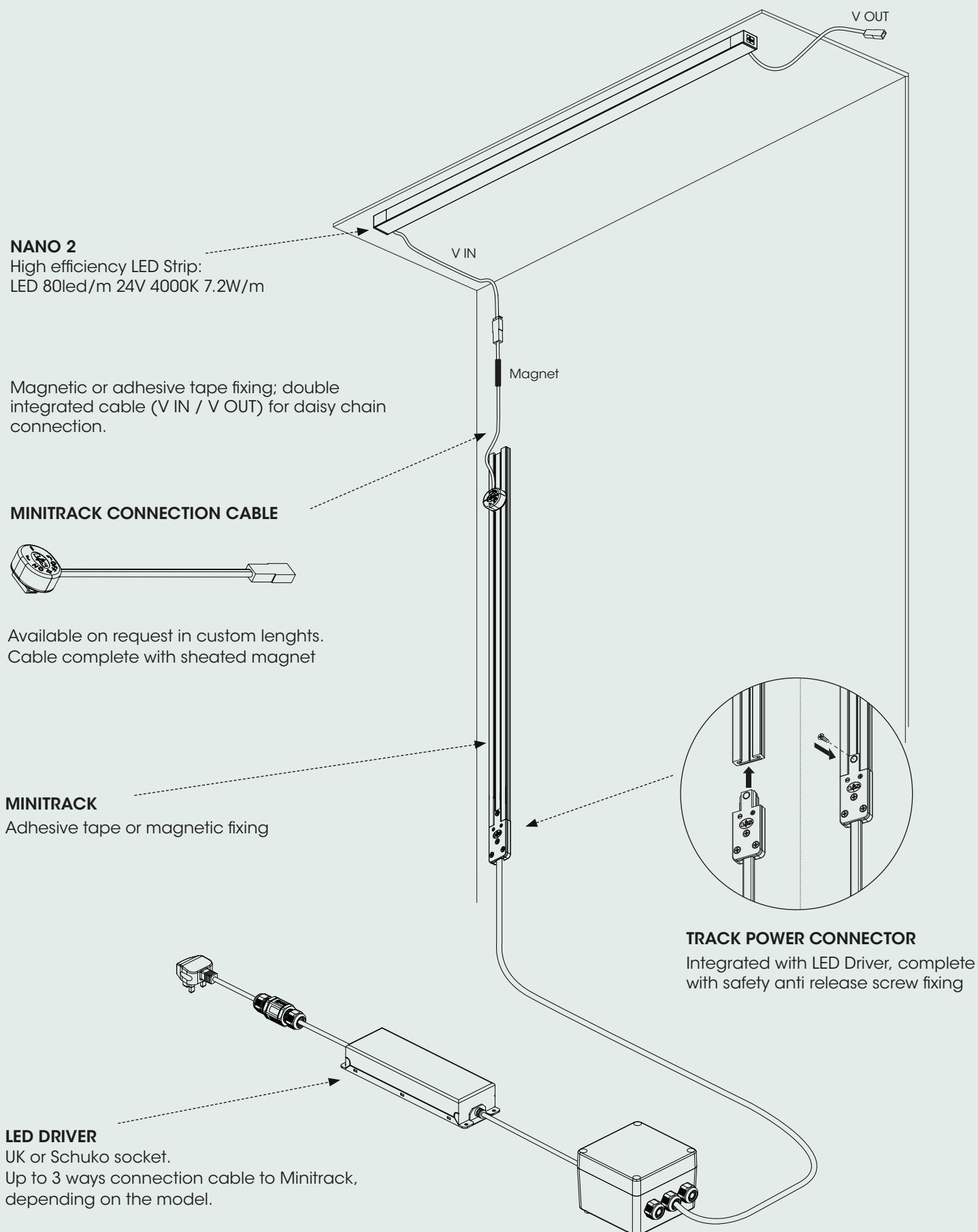

NANO 2 Lamp
DAISY CHAIN

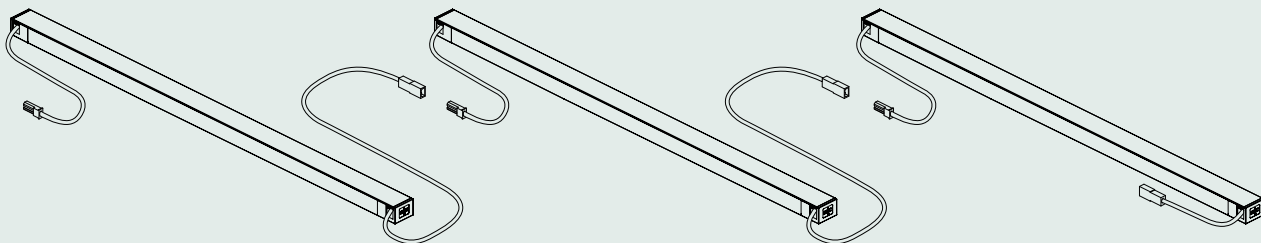

NANO 2 Lamp
VERSION A

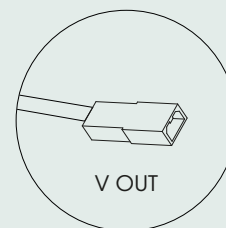
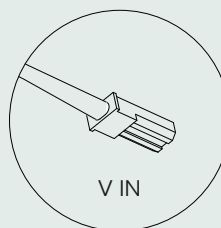
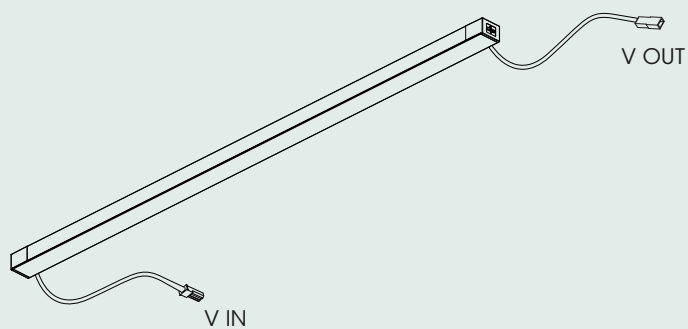

V IN cable with JST connector: must be coupled with a Minitrack connection cable (sold separately)

V OUT cable with JST connector for daisy chain connection to Version A Lamps

NANO 2 Lamp
VERSION B

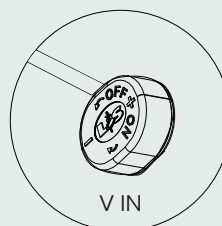
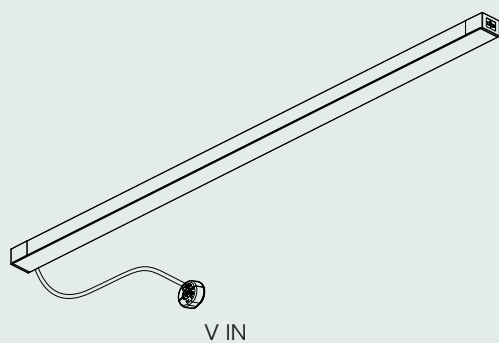

V IN cable complete with Minitrack connector (direct connection to track)

Setup example

MINITRACK N°1

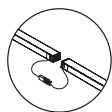

DAISY CHAIN CONNECTION
72W MAX

MINITRACK N°2

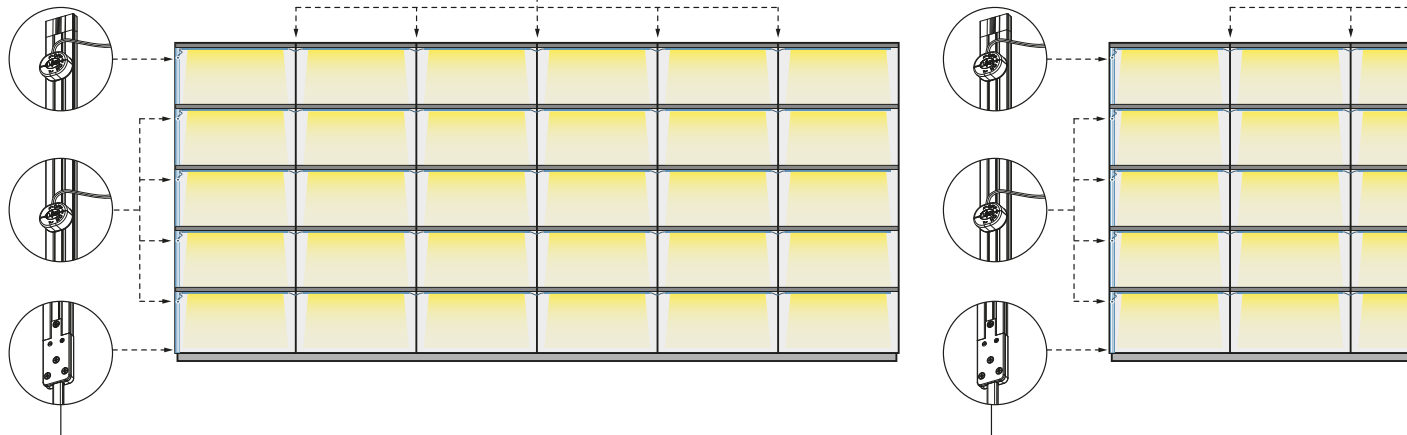

LED DRIVER
with 2 ways track
connection cables



MINITRACK
CONNECTION CABLES



DAISY CHAIN
CONNECTION

DAISY CHAIN
CONNECTION

DAISY CHAIN
CONNECTION

Revitalizing duo & kaki extract

“Every age is the happiest one. Un Natale da mordere.”

BODY CARE

Body Fit
Body Partner
Lift-Fermeté

Contouring

Plant Gold
Tonic
Baume Corps

Firming

Eau Dynamisante
Dynamic Delights

Specific care

UV Plus
SELF AN

Nano 2

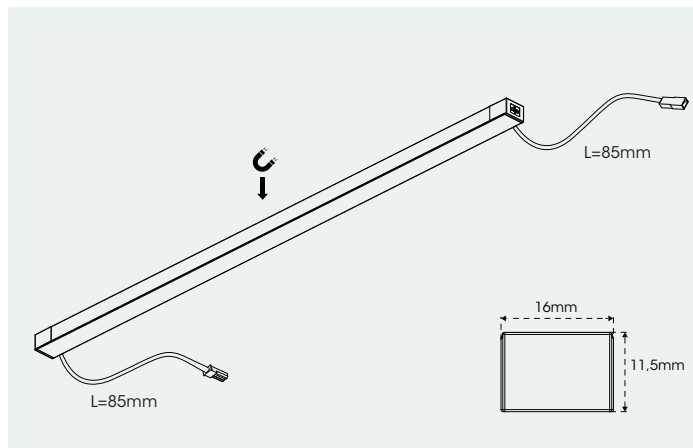

NANO 2 - 24V DC

12	92200161200DEN	500mm	3,3W	4000K
	92200171200DEN	665mm	4,6W	4000K
	92200181200DEN	800mm	5,9W	4000K
	92200191200DEN	1000mm	17,2W	4000K
	92200201200DEN	1250mm	9,1W	4000K
	92200231200DEN	1330mm	9,8W	4000K

Magnetic fixing / Adhesive tape fixing
Configurable with custom lengths

MINITRACK
Electrified track

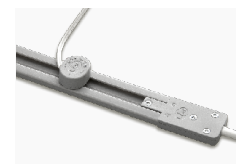

CONNECTION CABLE
For connection to Minitrack
electrified track

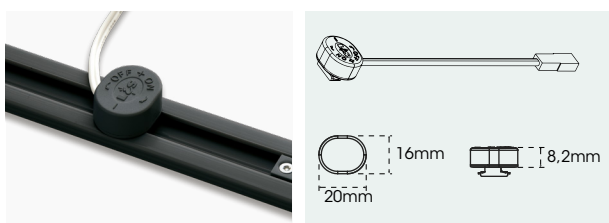

MINITRACK-LED CONNECTION CABLE

12	12608740000	230mm	max 3A	24V DC
	12608621000	280mm	max 3A	24V DC
	12608631000	460mm	max 3A	24V DC
	12608641000	860mm	max 3A	24V DC

Custom lengths on request
Minitrack connector available in White color

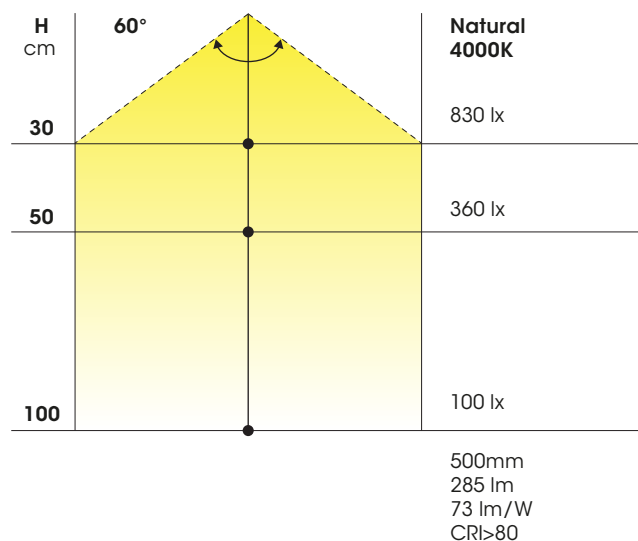

Nano 2

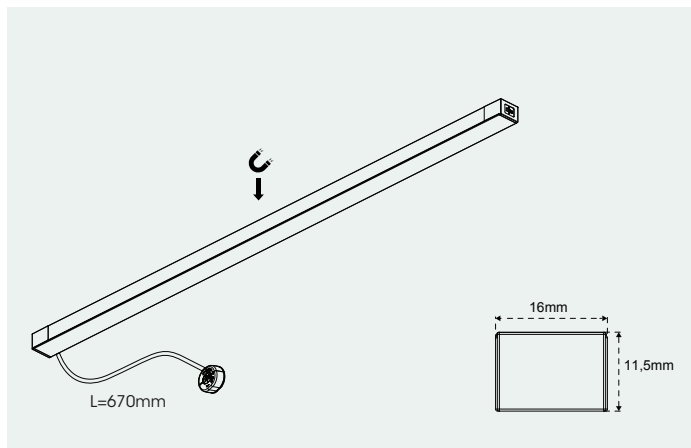

NANO 2 - 24V DC with minitrack cable

12	92200311200DEN	450mm	2,9W	4000K
	92200321200DEN	650mm	4,3W	4000K
	92200331200DEN	750mm	5,0W	4000K
	92200341200DEN	850mm	5,8W	4000K
	92200351200DEN	950mm	6,5W	4000K
	92200361200DEN	1150mm	7,9W	4000K
	92200371200DEN	1250mm	8,6W	4000K

Magnetic fixing / Adhesive tape fixing
Configurable with custom lengths

MINITRACK

Direct connection to electrified track with integrate Minitrack connector.

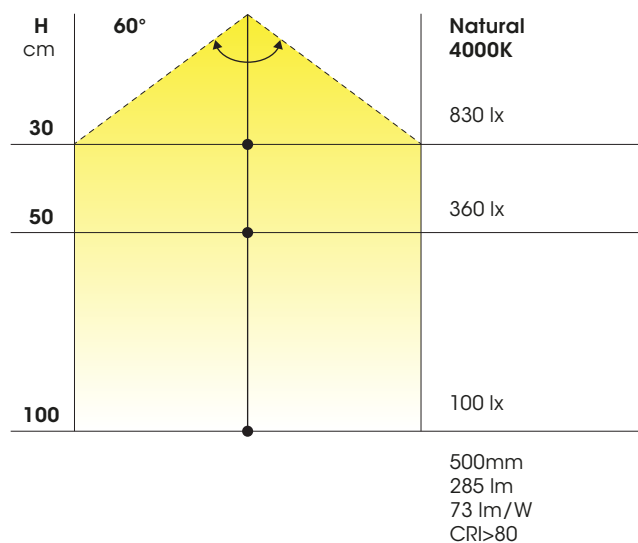
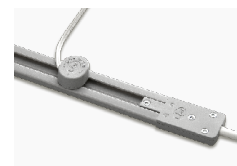

Minitrack

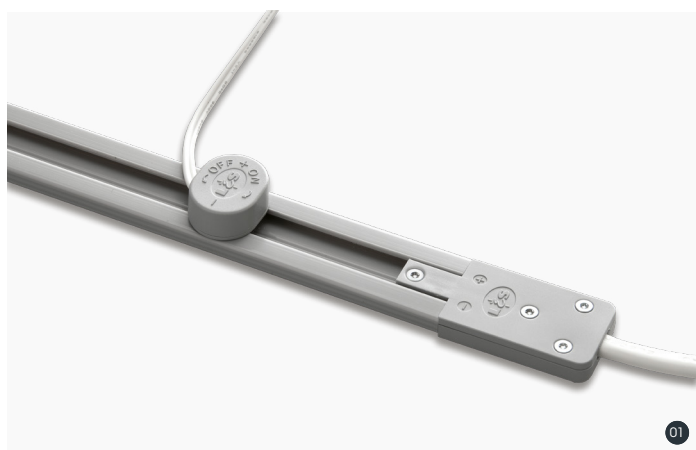

MINITRACK		Adhesive fixing		
10	12424761000	1200mm	24V DC	max 200W
01	12424760100	1200mm	24V DC	max 200W
10	12424751000	1800mm	24V DC	max 200W
01	12424750100	1800mm	24V DC	max 200W

MINITRACK		Magnetic fixing		
10	12424781000	1200mm	24V DC	max 200W
01	12424780100	1200mm	24V DC	max 200W
10	12424771000	1800mm	24V DC	max 200W
01	12424770100	1800mm	24V DC	max 200W

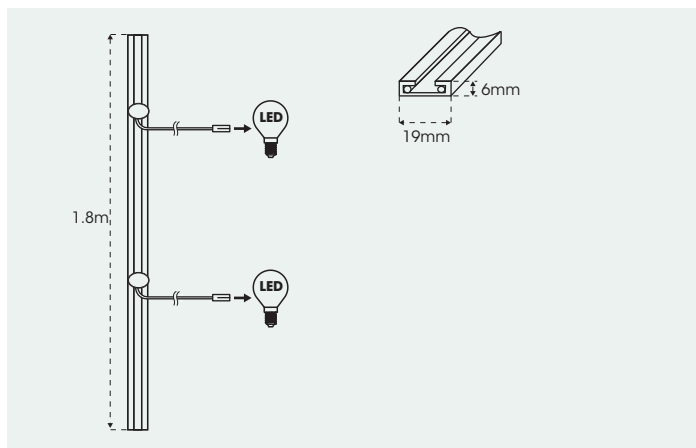

TRACK POWER CONNECTOR
Integrated in LED Driver
(sold separately)

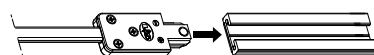

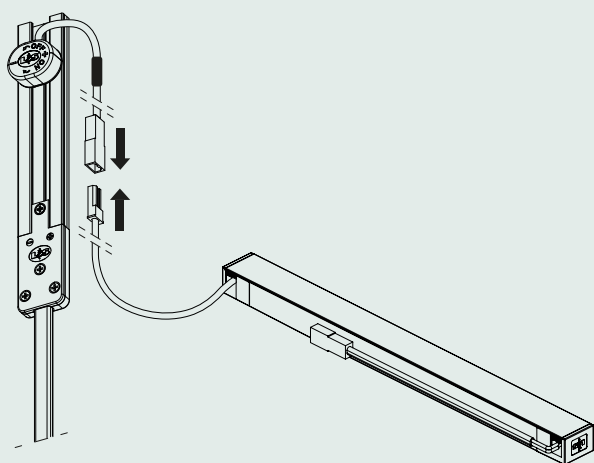
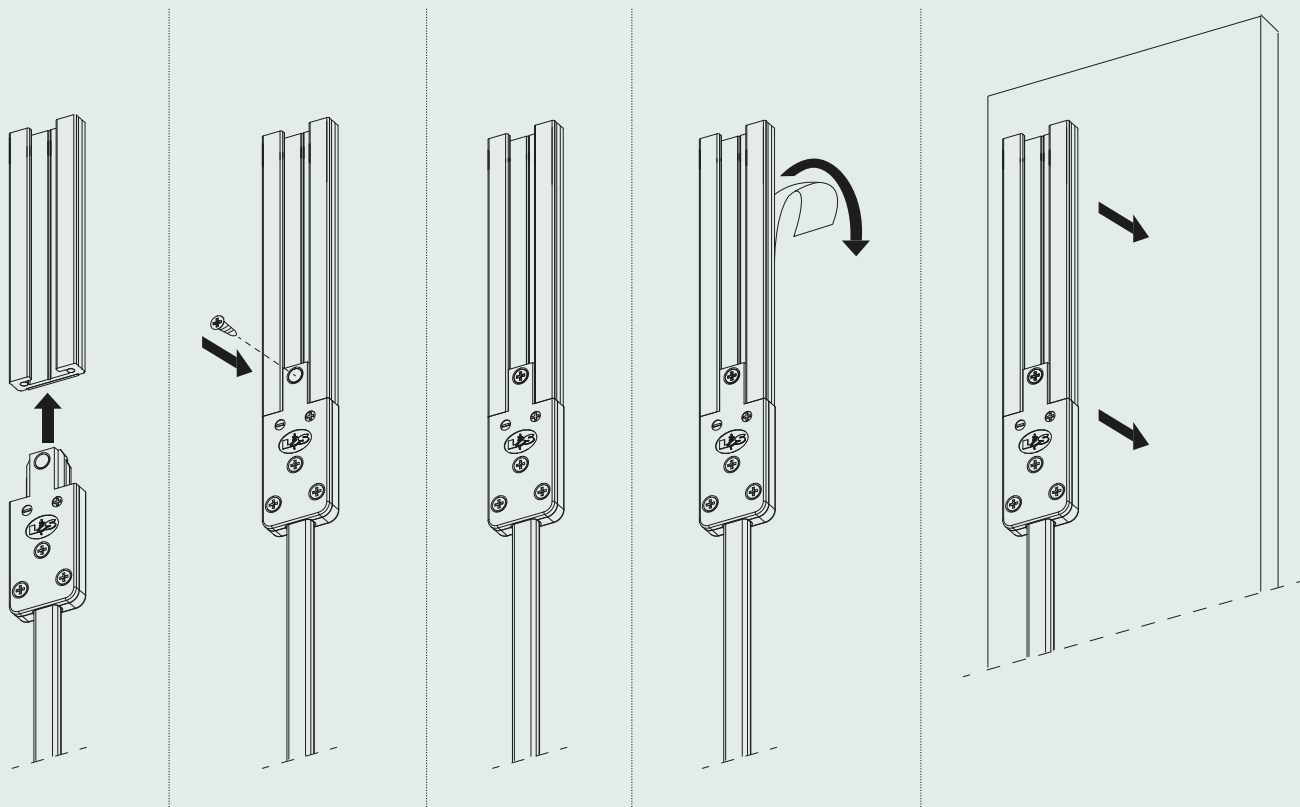

Connection to Nano 2 Lamp via Minitrack connection cable

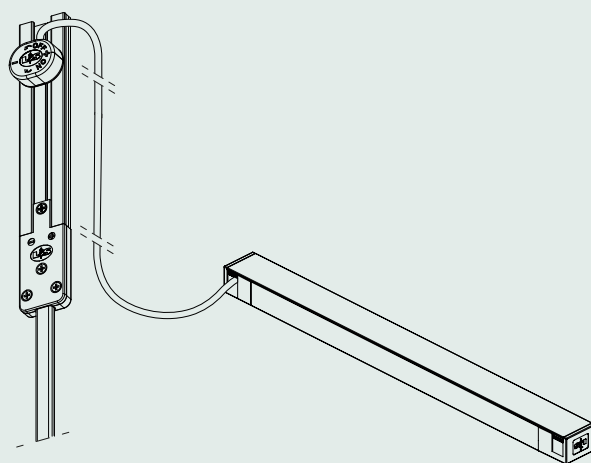

Direct connection to Nano 2 Lamps with integrated Minitrack connector

LED Driver

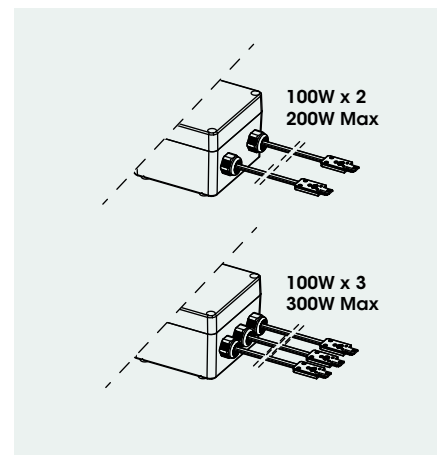
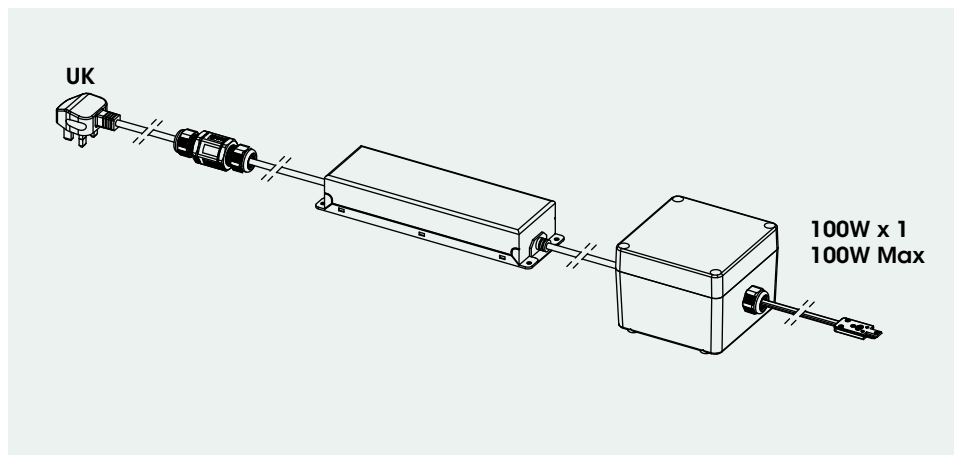

230V AC / 24V DC - UK PLUG With track power connector

12592400000	100W max	1 WAY (100W x 1)
12592410000	200W max	2 WAYS (100W x 2)
12592421000	320W max	3 WAYS (100W x 3)

TRACK POWER CONNECTOR
Integrated

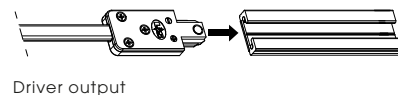

230V AC / 24V DC - SCHUKO PLUG With 10 ways twin distributor

12592520000	100W max	10 WAYS
-------------	----------	---------

FOR TWIN CONNECTOR
cod. 12608930000

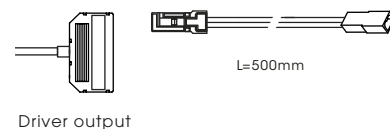

230V AC / 24V DC - SCHUKO PLUG With JST Connector

12592550001	75W max	2 WAYS
12592600000	200W max	3 WAYS

JST CONNECTOR
Integrated





ITAB

RETHINK RETAIL. TOGETHER.

Retail Lighting | Contact

ITAB Lighting
Europe, Asia, Middle East

Phone: +46 910 733 790
info@nordiclight.se